

SAFIR  
HOTELI



## CONFERENCE ROOMS CAPACITIES DAILY DELEGATE RATES

ATRIUMHOTEL



AMPHORA  
Hotel



# HOTEL ATRIUM / SPLIT - GROUND FLOOR



# HOTEL ATRIUM / SPLIT - GROUND FLOOR



## HOTEL ATRIUM / SPLIT - GROUND FLOOR

MEETING ROOM	m <sup>2</sup>	THEATRE	CLASSROOM	U SHAPE	IMPERIAL	COCKTAIL	BANQUET
DIOKLECIJAN	400	300	110	90	80	400	300
PERISTIL	132	113	45	40	36	120	70
CARRARA	147	123	48	42	38	150	80
MARUL	113	91	33	30	26	120	64
CARRARA + MARUL	260	170	80	70	65	270	150
PERISTIL + CARRARA	279	230	85	72	68	300	120
DIOKLECIJAN + PRISKA	700	-	-	-	-	700	400

# HOTEL AMPHORA / SPLIT - GROUND FLOOR

CITREA, PRUNUS, FIKUS, IUGLANDIS

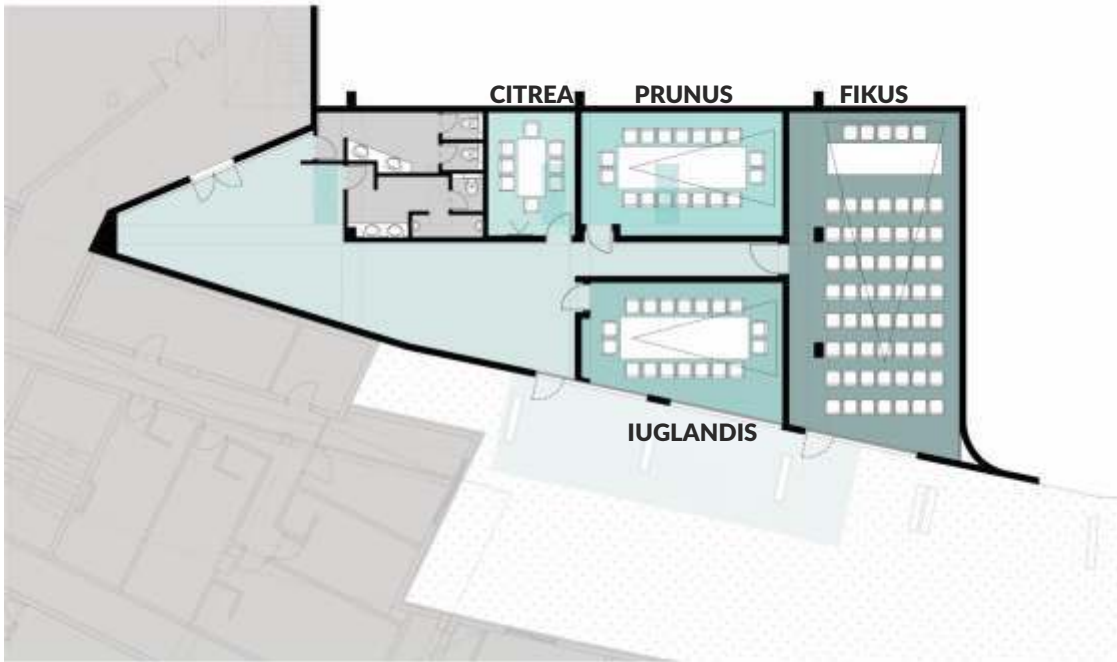

MEGARON

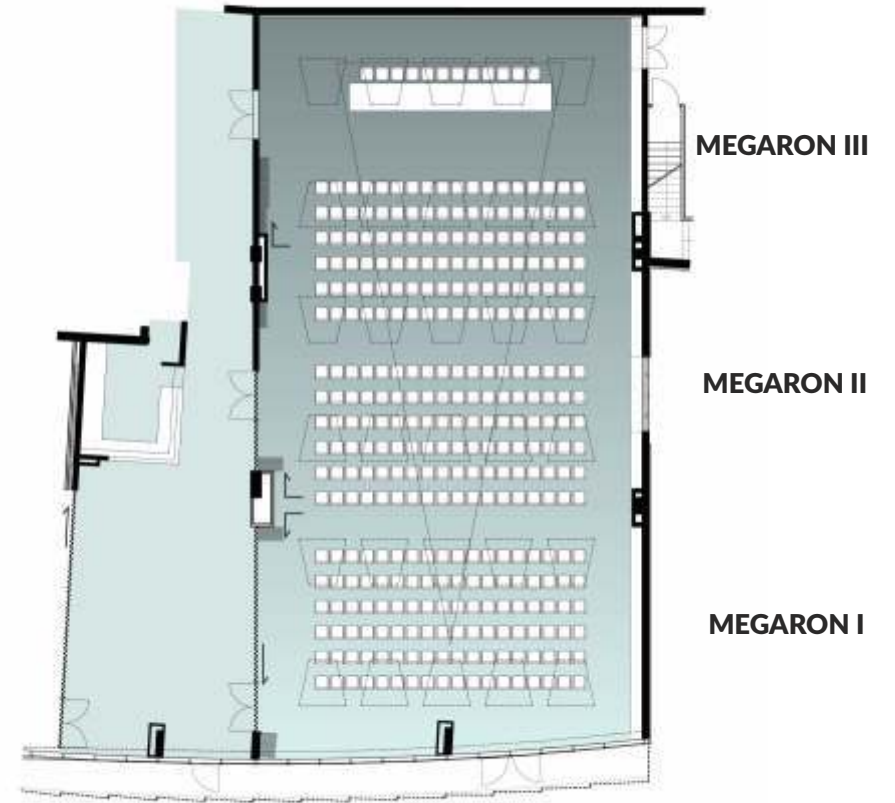

## HOTEL AMPHORA / SPLIT - GROUND FLOOR

FUNCTION ROOM	DIMENSIONS	m <sup>2</sup>	HIGH	THEATRE	CLASSROOM	U SHAPE	COCKTAIL	BANQUET	BOARD ROOM
MEGARON	14.50 x 28.90 m	420	4 m	500	200	70	400	350	-
MEGARON I	14.50 x 9.30 m	135	4 m	170	65	25	120	110	-
MEGARON II	14.50 x 9.20 m	133	4 m	170	65	25	120	110	-
MEGARON III	14.50 x 10.40 m	151	4 m	190	75	25	130	125	-
CITREA	3.00 x 4.30 m	13	2.80 m	-	-	-	-	-	8
PRUNUS	7.00 x 4.30 m	30	2.80 m	34	12	-	-	-	18
FIKUS	6.00 x 11.50 m	69	2.80 m	80	30	-	-	-	40
IUGLANDIS	7.00 x 4.30 m	30	2.80 m	34	12	-	-	-	18

# DAILY DELEGATE RATES

## DAILY DELEGATE RATES

(min 15 persons)

### Daily Delegate Rate 370,00 kn

Conference room, audio/visual equipment (projector and projection screen), flipchart  
Three course business lunch menu including soft drinks, juices and mineral water  
Morning coffee break with cookies, afternoon coffee break with fresh fruit

### Half day delegate rates 300,00 kn

(Up to 4 working hours)

Half day Delegate Rates includes:

Conference room, audio/visual equipment (projector and projection screen), flipchart  
Three course business lunch menu, coffee break with cookies

### Surcharge for buffet lunch menu 35,00 kn (min. 35 persons)

Buffet menu 1 - 3

### Surcharge for buffet lunch menu 50,00 kn - (min. 35 persons)

Buffet menu 4 - 6